



## Westbourne Park Villas, Notting Hill

London, W2

In Excess of **£2,000,000**

SOMMERVILLE FLURY

# Westbourne Park Villas, Notting Hill, W2

## *Property Description:*

This striking two bedroom, two bathroom duplex apartment on the first and top floors of a period building in a sought after location in Notting Hill. Access to the apartment is through a private entrance which has stairs leading to the living spaces that have been designed to an exceptionally high standard, embracing luxurious contemporary living.

The first floor's large reception area with dual aspect boasts modern interiors with traditional style stone fireplaces, and the fully-fitted bespoke Roundhouse kitchen is sure to impress even the most discerning of cooks. The care and dedication taken to maximise each space is evident throughout this property, with bespoke finishes that marry harmoniously with elegant period features.

The floating timber and glass staircase links the floors and both bedrooms are generously proportioned, including fitted wardrobes and en-suite bathroom with details such as frameless glass shower enclosures and herringbone tiled panels to bathrooms.





# Westbourne Park Villas, Notting Hill, W2

## ***Location:***

Westbourne Park Villas is located in the heart of Notting Hill; one of London's most desirable locations. Idyllic streetscapes and the buzz of Westbourne Grove is a stone's throw away. This area has grown to be one of London's most stylish districts - an area awash with outstanding restaurants, bars and designer shops.

Nearby transport links include Westbourne Grove and Royal Oak (Circle, Hammersmith & City lines). For motorists, the A40 is easily accessible.

Tenure: Leasehold. 998 years remaining



## Westbourne Park Road, W2

Approx. Gross Internal Area  
121.2 sq m / 1304 sq ft

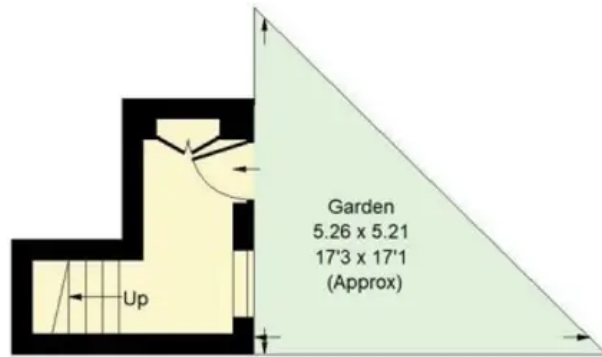

Ground Floor



First Floor



Second Floor

Whilst every attempt has been made to ensure the accuracy of the floor plan, measurements are approximate and not to scale.  
No guarantee is given on the total square footage of the property quoted on the plan. Figures given are for guidance.  
Plan is for illustration purposes only, not to be used for valuations.

# SOMMERVILLE FLURY

---

+44 (0)20 3479 5314

21 Ellis Street, Knightsbridge, London SW1X 9AL

[info@sommervilleflury.com](mailto:info@sommervilleflury.com)

[www.sommervilleflury.com](http://www.sommervilleflury.com)